

## GB15 Heavy Duty T-Handle (Titan Series 185mm)

### Features

- The full-length versions of the 'Titan' series have 'tail' turned inwards for good appearance and to reduce surface projection
- Metal section at the base of the handle casting is more than twice usual thickness, preventing fracture and resisting lateral loads
- Large size, wide section for good grip, convenience of external mounting but with screws fully concealed when locked, doubled-sided keys as standard
- 180° rotation as standard, rotation can be limited to 90°, LH/RH, or to the special '180° horizontal' option. Handles lock at each 90° position.

### Notes

- Fix through countersunk holes at 44 mm centres, which are completely hidden when handle is locked. Neoprene gasket supplied.
- 'FT' double-sided keys as standard with 'shuttered' keyway. Alternatively 'FS', or 'DLP' key types also available
- **Contact Gripwell sales for cam pawl and centre-case options**



**GB15-G01038**  
(Non-locking handle)



**GB15-G01037**  
(Locking handle)



Mounting holes at 44 mm centres are totally hidden when handle is locked

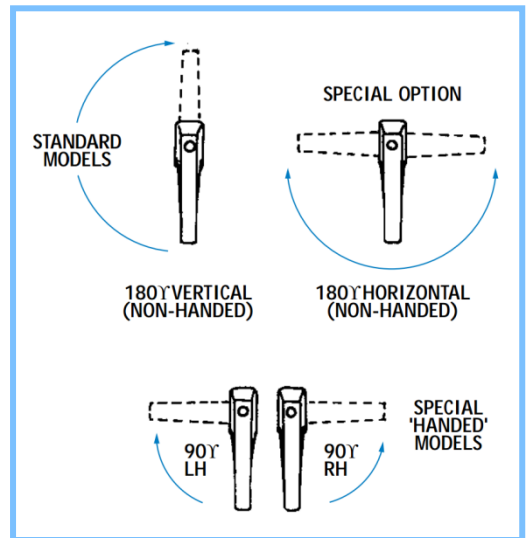
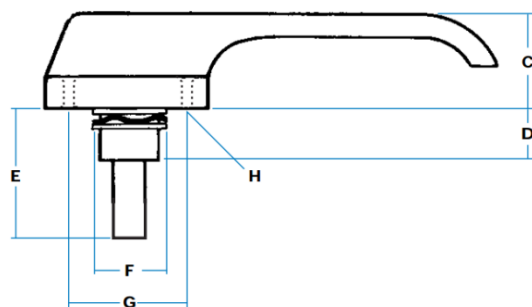
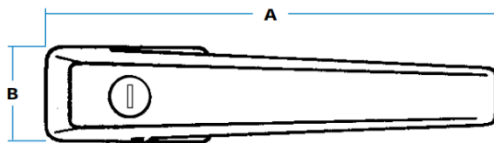

Handles operate through 180° as standard (non-handed). Rotation can be limited to 90° LH (clockwise) or 90° RH (anticlockwise), or to special order, to 180° horizontal movement as shown. Handles will lock in each 90° position.

| Part No.    | Type       | Key         | A   | B  | C  | D  | E   | F  | G  | H                  |
|-------------|------------|-------------|-----|----|----|----|-----|----|----|--------------------|
| GB15-G01037 | Non-Handed | Locking     | 185 | 37 | 41 | 18 | 130 | 28 | 44 | 5 mm,<br>c/s 10 mm |
| GB15-G1038  |            | Non-Locking |     |    |    |    |     |    |    |                    |
| GB15-G1071  | LH         | Locking     |     |    |    |    |     |    |    |                    |
| GB15-G1035  |            | Non-Locking |     |    |    |    |     |    |    |                    |
| GB15-G1072  | RH         | Locking     |     |    |    |    |     |    |    |                    |
| GB15-G1036  |            | Non-Locking |     |    |    |    |     |    |    |                    |

## Die Cast Cams & Heavy Duty Cam Pawls

### Features

- Our die cast cams provide the simplest way of securing an enclosure door. They fit onto a plain, 8 mm-square shaft, and are clamped into position with the integral socket screw. A version is available with hole threaded M8, to suit corresponding round shaft.
- The range of heavy steel cams (below) is normally fitted to our 'drop-T' series, but they can be used with any 8 mm square shaft, normally threaded M10 with securing nuts to allow for adjustment and retention. Finish is bright zinc-plated.
- All cams are fitted with hexagon-head grub screw, adjusted by 3/32" Allen key (threaded 10/32 UNF x 3/8")



**G27296**  
(Small cam)



**G00837**  
(Large cam)

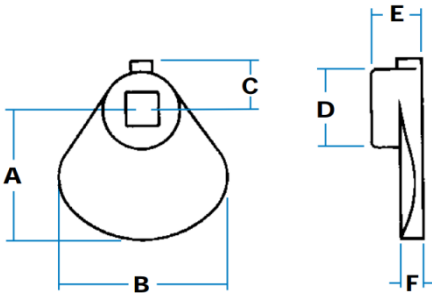

| Part No.      | Description                    | A  | A1 | B  | C  | D  | E  | F |
|---------------|--------------------------------|----|----|----|----|----|----|---|
| <b>G27296</b> | Small cam,<br>8 mm square hole |    |    |    |    |    |    |   |
| <b>G27297</b> | Small cam,<br>M8 threaded hole | 32 | 63 | 40 | 11 | 19 | 13 | 4 |
| <b>G00837</b> | Large cam,<br>8 mm square hole |    |    |    |    |    |    |   |

Heavy-duty cam pawls, made in rolled-edge mild steel, 30 mm width x 5 mm deep, with 3 mm 'V' raise for cam-action

